

158cm
62 1/4"

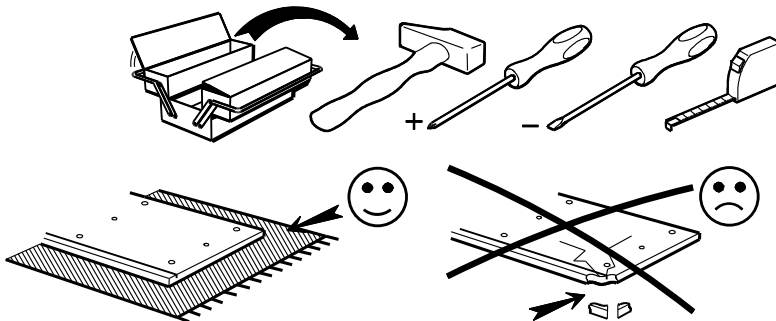

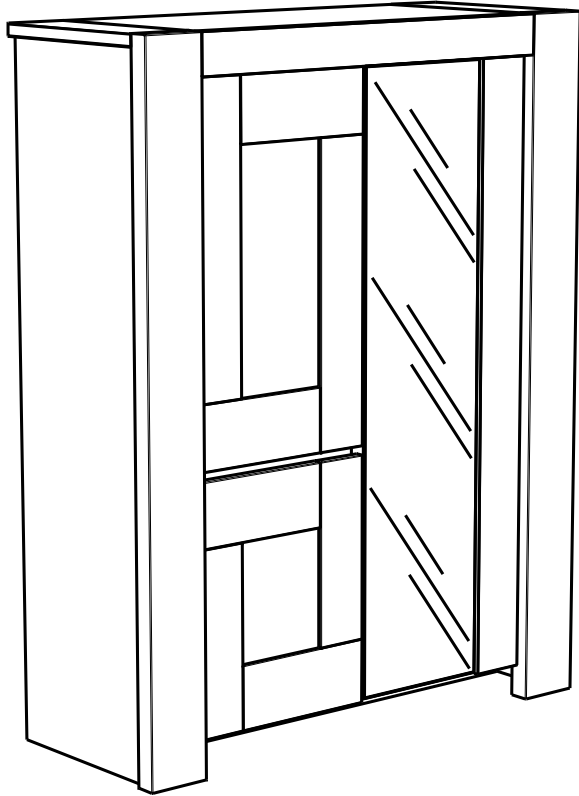

| | | mm | | | inch | | | |
|------|-----|------|-----|----|----------|---------|-------|---|
| (23) | x 1 | 0 | 0 | 0 | | | | . |
| (8) | x 1 | 434 | 145 | 28 | 17 1/16 | 5 11/16 | 1 1/8 | . |
| (4) | x 1 | 434 | 145 | 28 | 17 1/16 | 5 11/16 | 1 1/8 | . |
| (14) | x 1 | 444 | 30 | 22 | 17 1/2 | 1 3/16 | 7/8 | . |
| (16) | x 1 | 542 | 60 | 15 | 21 5/16 | 2 3/8 | 9/16 | . |
| (21) | x 1 | 560 | 360 | 0 | 22 1/16 | 14 3/16 | | . |
| (15) | x 2 | 597 | 350 | 15 | 23 1/2 | 13 3/4 | 9/16 | . |
| (13) | x 1 | 597 | 392 | 15 | 23 1/2 | 15 7/16 | 9/16 | . |
| (22) | x 1 | 828 | 360 | 0 | 32 9/16 | 14 3/16 | | . |
| (18) | x 1 | 905 | 60 | 15 | 35 5/8 | 2 3/8 | 9/16 | . |
| (11) | x 1 | 939 | 92 | 28 | 36 15/16 | 3 5/8 | 1 1/8 | . |
| (10) | x 1 | 939 | 454 | 22 | 36 15/16 | 17 7/8 | 7/8 | . |
| (2) | x 1 | 1164 | 77 | 15 | 45 13/16 | 3 | 9/16 | . |
| (1) | x 1 | 1164 | 434 | 15 | 45 13/16 | 17 1/16 | 9/16 | . |
| (17) | x 1 | 1461 | 60 | 15 | 57 1/2 | 2 3/8 | 9/16 | . |
| (20) | x 1 | 1467 | 40 | 16 | 57 3/4 | 1 9/16 | 5/8 | . |
| (19) | x 1 | 1467 | 413 | 15 | 57 3/4 | 16 1/4 | 9/16 | . |
| (7) | x 1 | 1552 | 434 | 15 | 61 1/8 | 17 1/16 | 9/16 | . |
| (3) | x 1 | 1552 | 434 | 15 | 61 1/8 | 17 1/16 | 9/16 | . |
| (9) | x 1 | 1580 | 145 | 48 | 62 3/16 | 5 11/16 | 1 7/8 | . |
| (5) | x 1 | 1580 | 145 | 48 | 62 3/16 | 5 11/16 | 1 7/8 | . |
| (22) | x 1 | | | | | | | . |
| (21) | x 1 | | | | | | | . |
| | | | | | | | | . |
| (25) | x 4 | 551 | 340 | 4 | 21 11/16 | 13 3/8 | 3/16 | . |
| (24) | x 1 | 1483 | 567 | 3 | 58 3/8 | 22 5/16 | 1/8 | . |
| (12) | x 1 | 1483 | 613 | 3 | 58 3/8 | 24 1/8 | 1/8 | . |
| | | | | | | | | . |

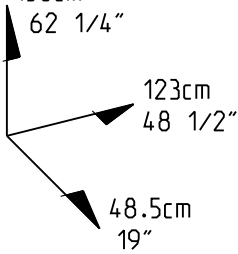
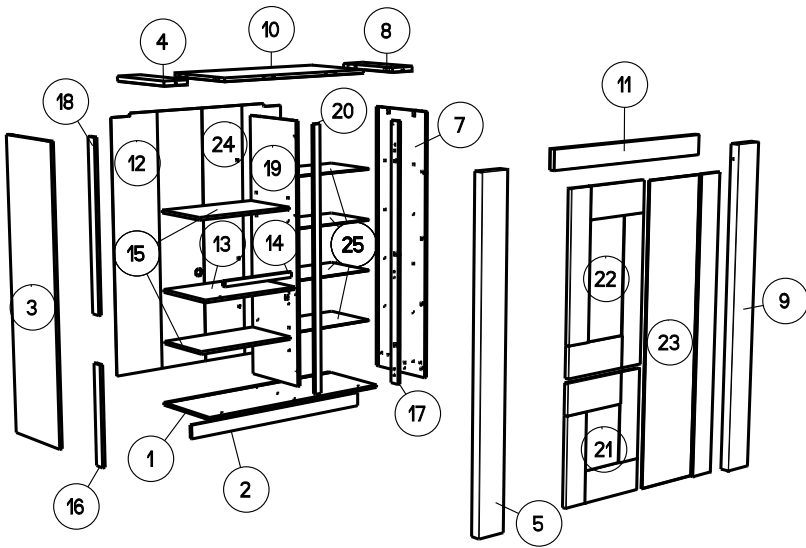
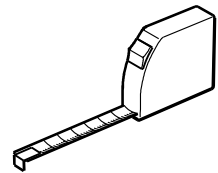

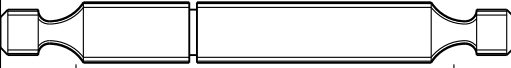
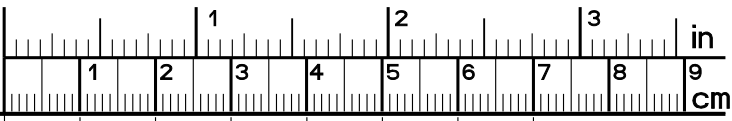

AKY x 4

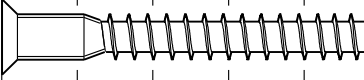

HW x 5

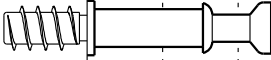

BWC x 41



ADM x 23

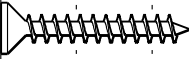

VJ x 9

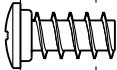

VB x 10

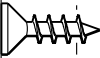

VG x 5



ANK x 4



BLL x 6



EP x 4

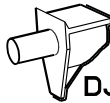

DJ x 16



FA x 4



BWD x 8



Ai x 49

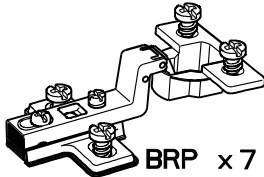

BRP x 7



HV x 1



BQV x 1

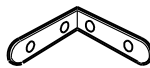

LN x 1

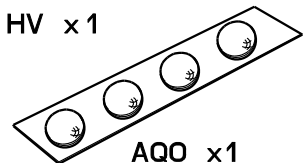

AQO x 1

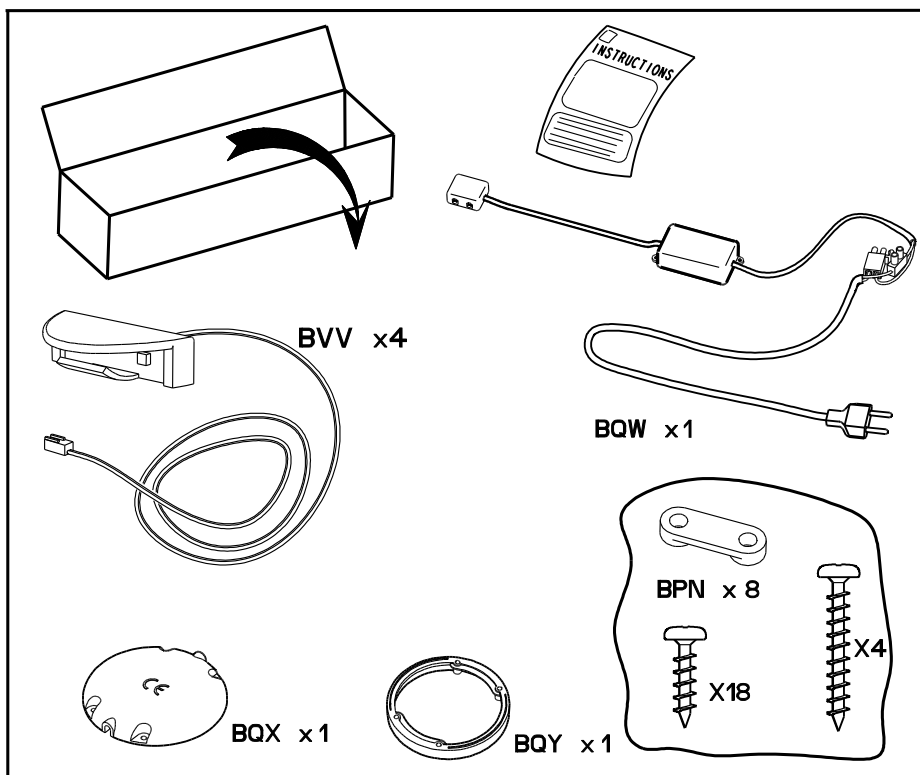

- (F) INSTALLATION DE L'ECLAIRAGE
- (GB) INSTALLING THE LIGHTING
- (D) INSTALLATION MIT BELEUCHTUNG
- (E) INSTALACION DE LA ILUMINACION
- (P) INSTALACAO DA ILUMINACAO
- (I) INSTALLAZIONE DELL'ILLUMINAZIONE
- (NL) INSTALLEREN VAN DE VERLICHTING

- (F) NE PAS RELIER A LA TERRE
- (GB) DO NOT EARTH
- (D) NICHT AN ERDE ANSCHLIESSEN
- (E) NO UNIR A LA TIERRA
- (P) NAO LIGAR A TERRA
- (I) NON COLLEGARLA A TERRA
- (NL) NIET MET DE AARDE VERBINDEN

- (F) SI LE CABLE EXTERIEUR SOUPLE OU LE CORDON DE CE LUMINAIRE EST ENDOMMAGE, IL DOIT ETRE REMPLACÉ EXCLUSIVEMENT PAR LE FABRICANT, OU TOUTE PERSONNE DE QUALIFICATION EQUIVALENTE, CECI AFIN D'ÉVITER TOUT RISQUE.
- (GB) IF THE EXTERIOR FLEX OR THE CORD OF THIS LIGHT FITTING IS DAMAGED, IT MUST BE REPLACED BY THE MANUFACTURER OR AN EQUALLY QUALIFIED PERSON TO AVOID ANY RISK.
- (D) WENN DAS AUßERE KABEL ODER DAS STROMKABEL DIESER LAMPE BESCHADIGT IST DARF ES NUR VON EINEM FACHMANN AUSGEWECHSELT WERDEN, UM JEGLICHES RISIKO ZU VERMEIDEN.
- (E) EN CASO DE QUE EL CABLE EXTERIOR FLEXIBLE O EL CORDON DE ESTE ALUMBRADO ESTE DANADO, SE DEBERA PROCEDER A SU SUSTITUCION POR EL FABRICANTE O CUALQUIER PERSONA CON CALIFICACION EQUIVALENTE, CON EL FIN DE EVITAR CUALQUIER RIESGO.
- (P) SE O CABO EXTERIOR FLEXIVEL OU O CABO DE LIGACAO DESTA LUMINARIA FOR DANIFICADO, DEVERA SER SUBSTITUIDO EXCLUSIVAMENTE PELO FABRICANTE, OU POR PESSOA DE QUALIFICACAO EQUIVALENTE, A FIM DE EVITAR QUALQUER RISCO
- (I) SE IL CAVO ESTERNO O ELECTTRICO DI QUESTA LAMPADA E DANNEGGIATO, LA SOSTITUZIONE DEVE AVVENIR SOLO DA PARTE DI PERSONALE SPECIALIZZATO, PER EVITARE QUALSIASI TIPO DI RISCHIO.
- (NL) ALS DE SOEPELE BUITENKABEL OF HET SNOER VAN DE LAMP BESCHADIGD IS, MAG DEZE ALLEEN DOOR DE FABRIKANT OF IEMAND MET EEN GELIJKWAARDIGE KWALIFICATIE WORDEN VERVANGEN, OM ELK RISICO TE VERMIJDEN.

1

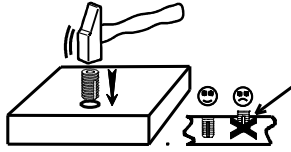
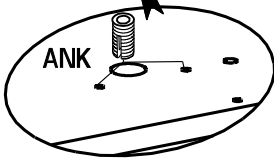
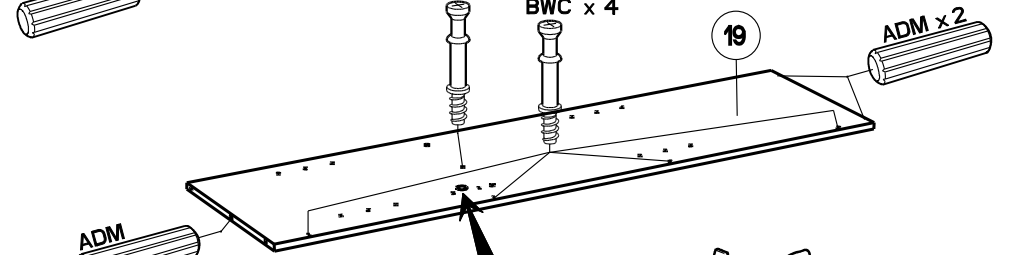
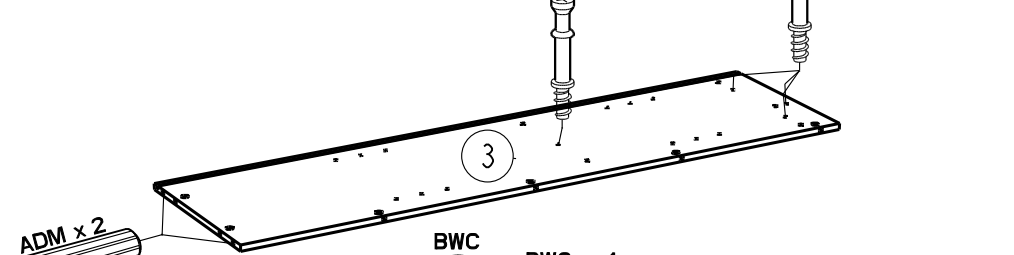
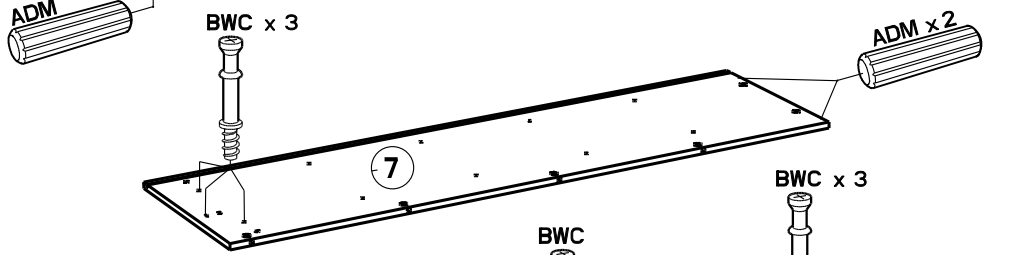
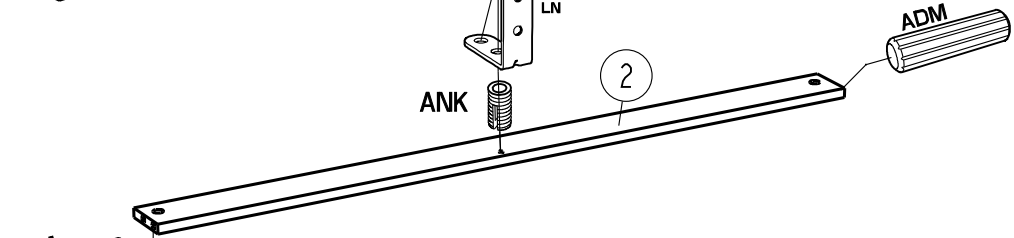
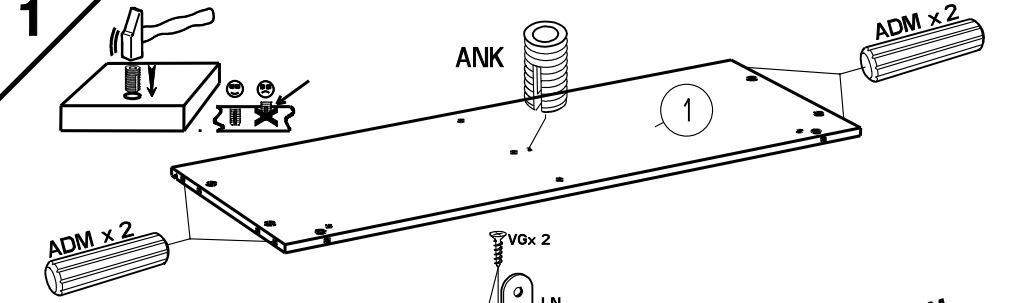
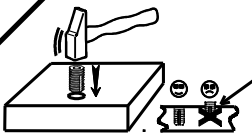

2

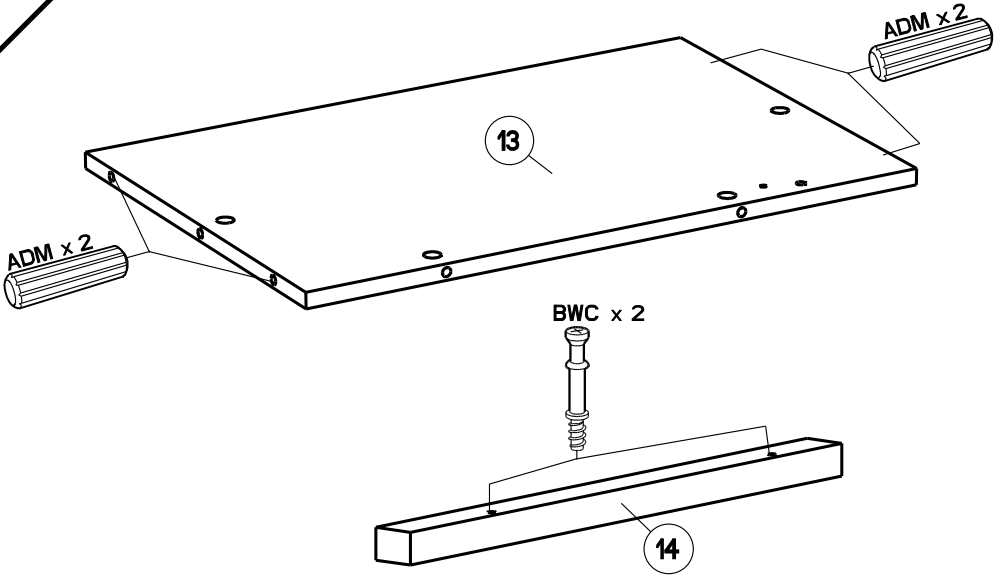

3

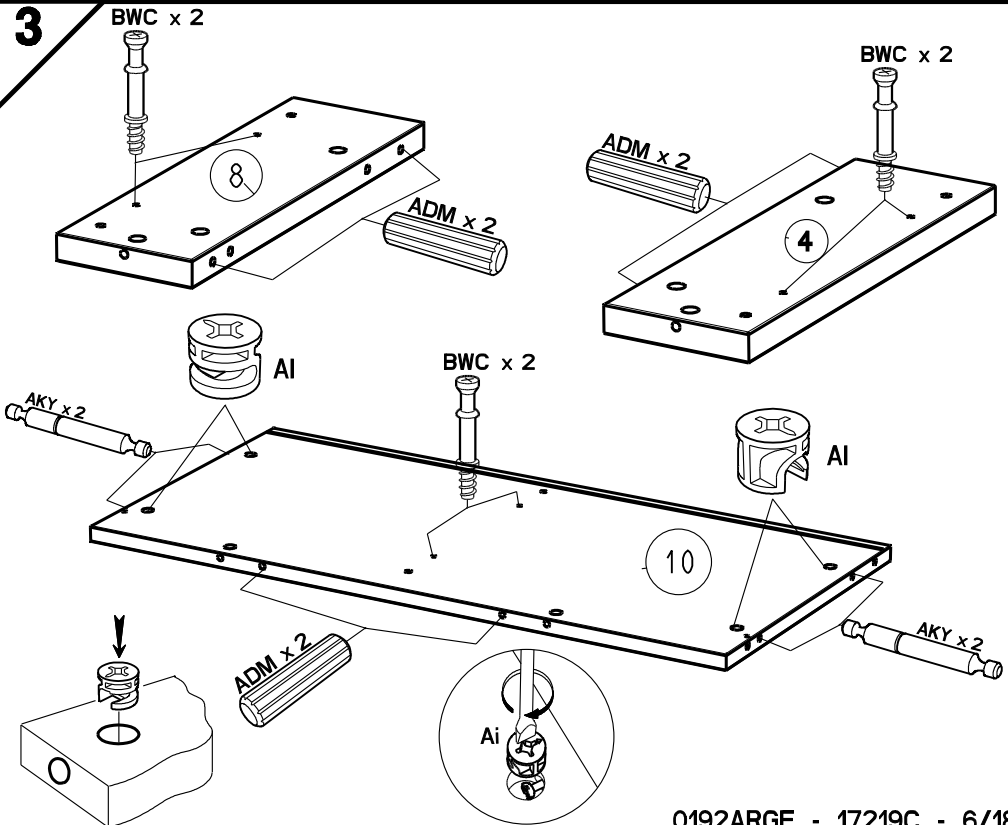

4

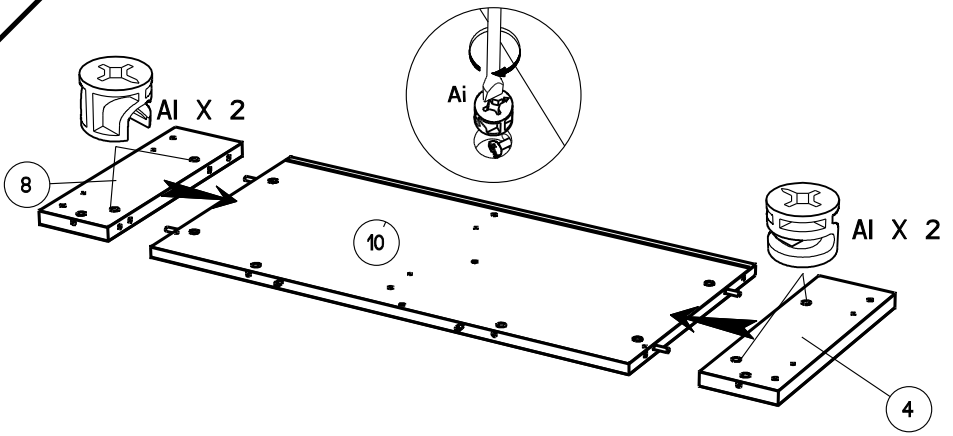

5

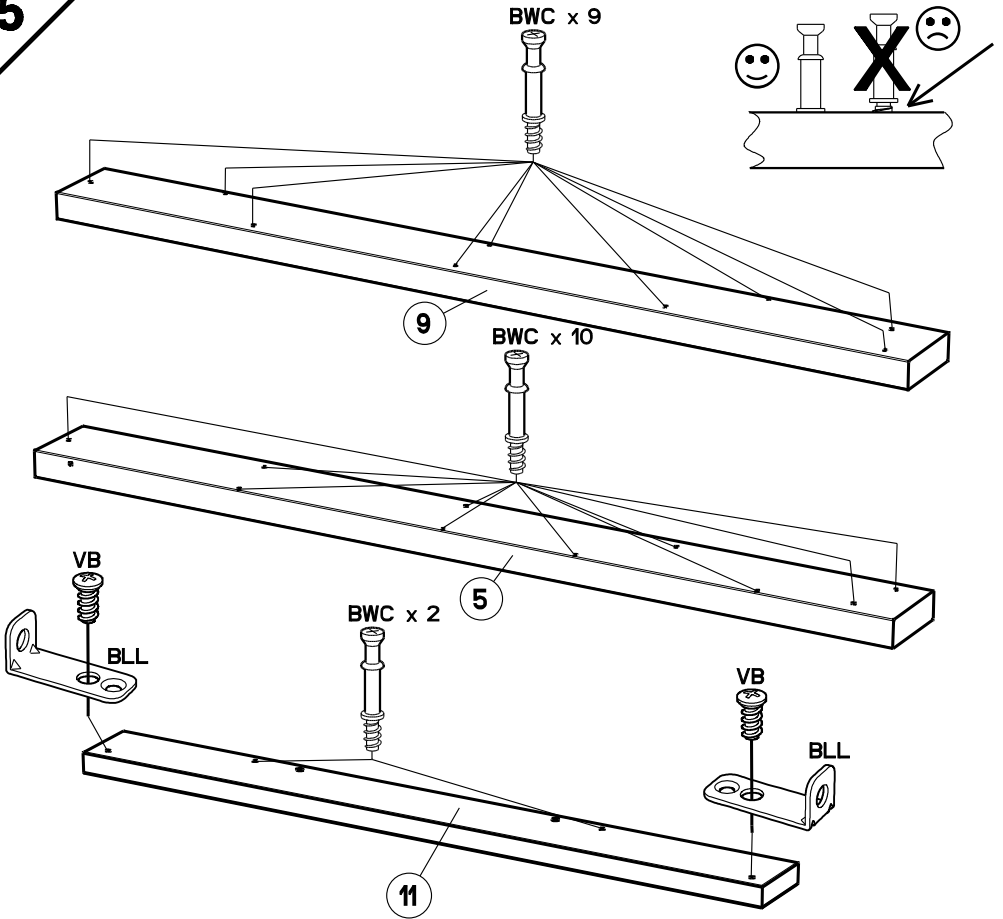

6

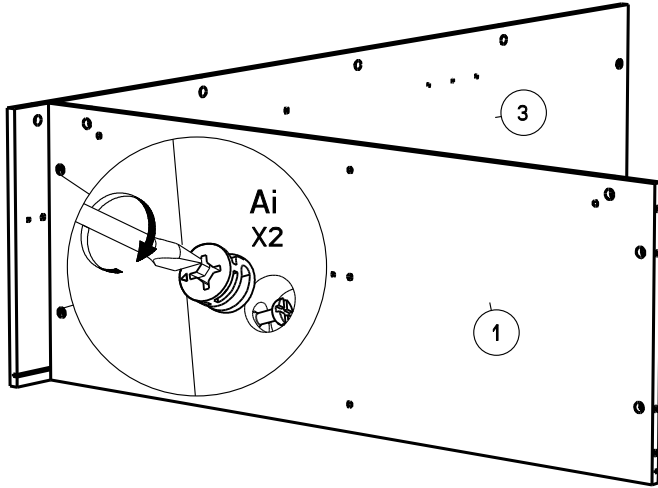

7

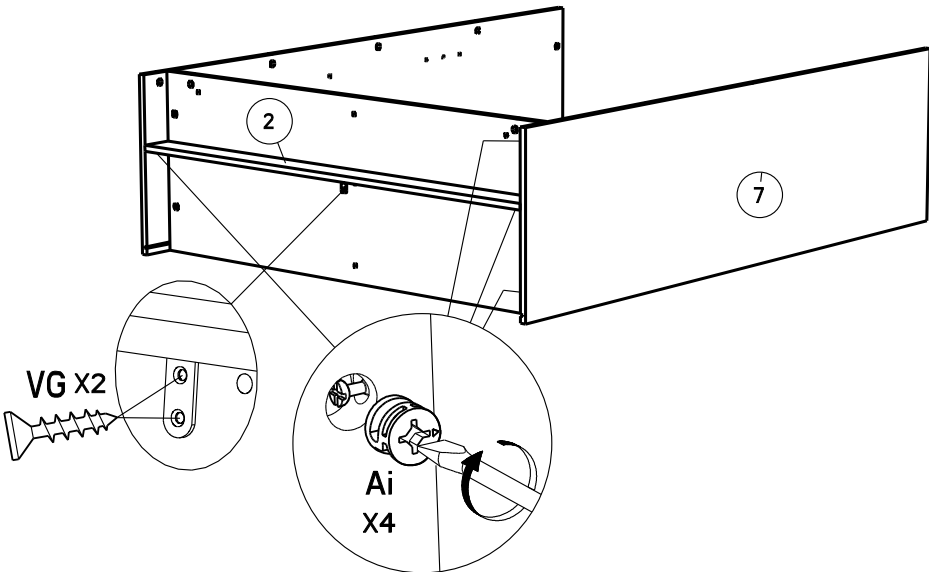

8

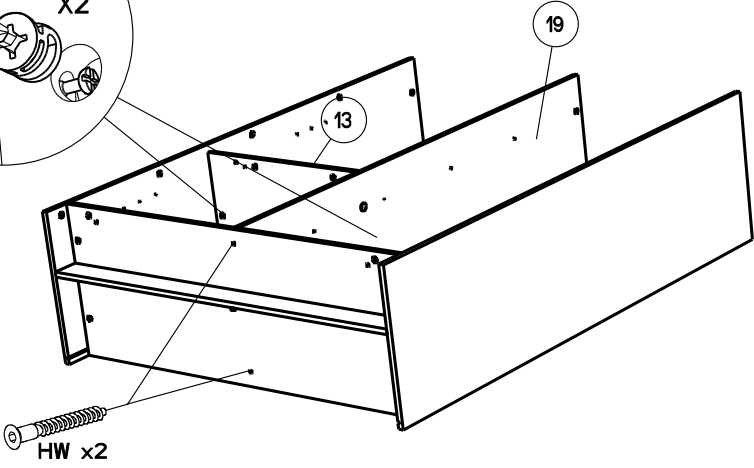
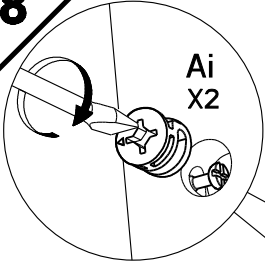

9

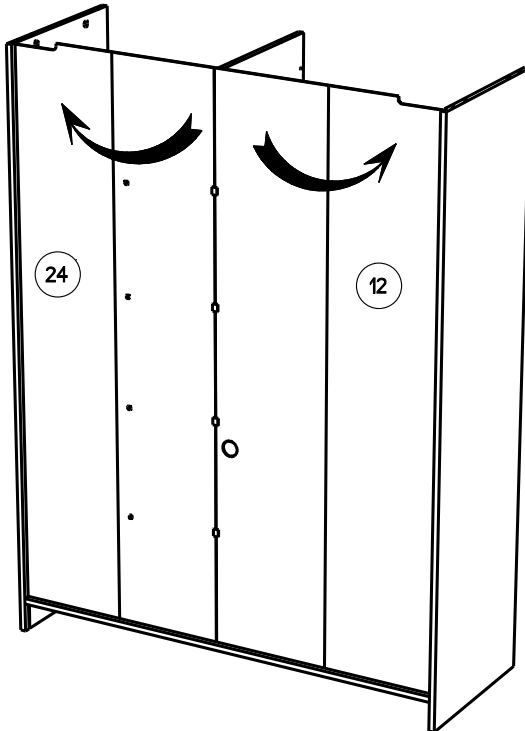

10

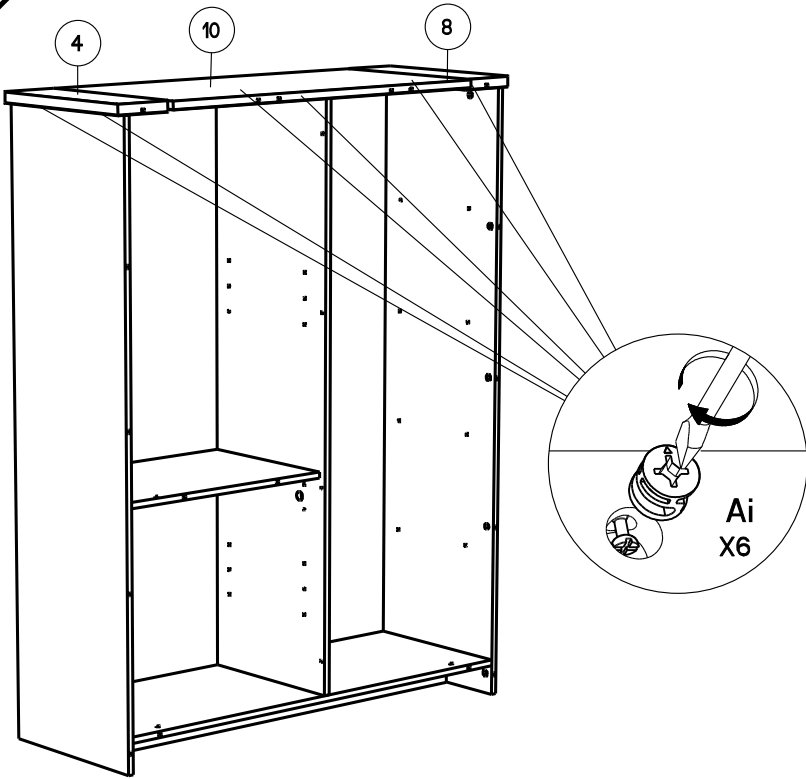

11

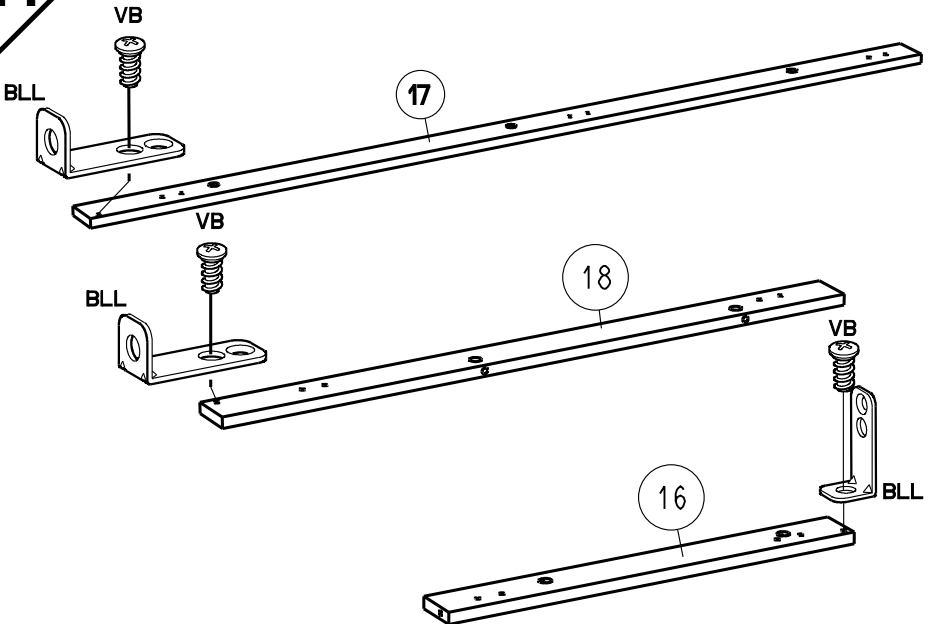

12

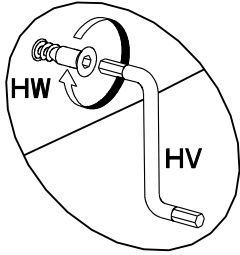
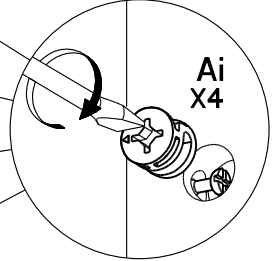
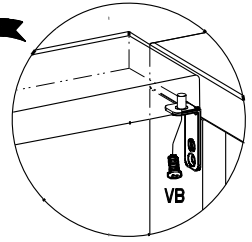
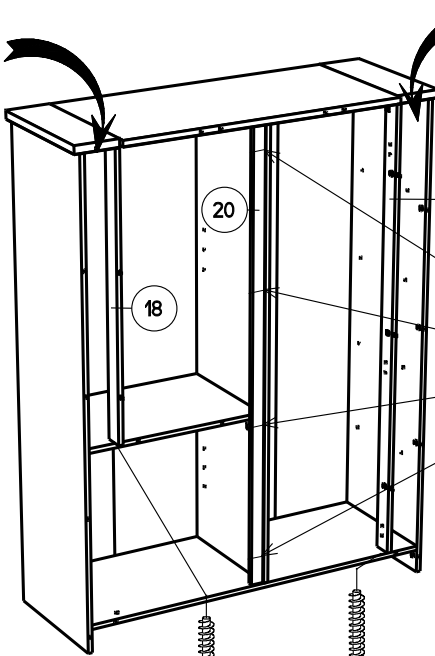
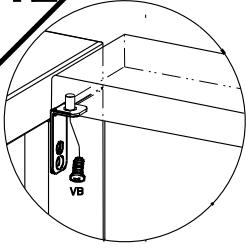

13

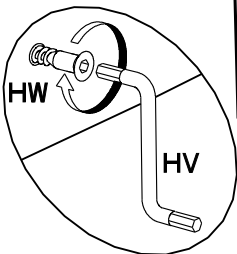
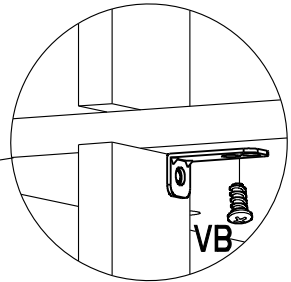
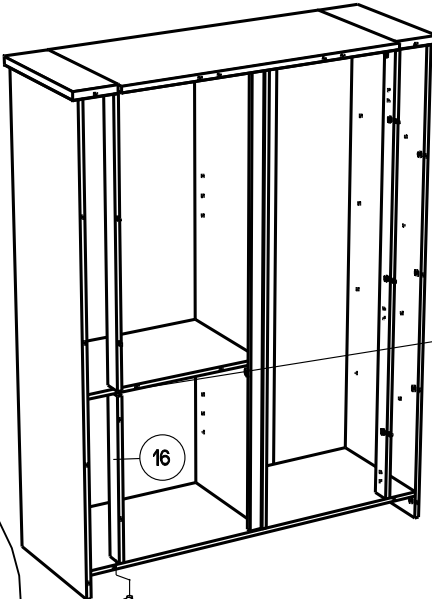

14

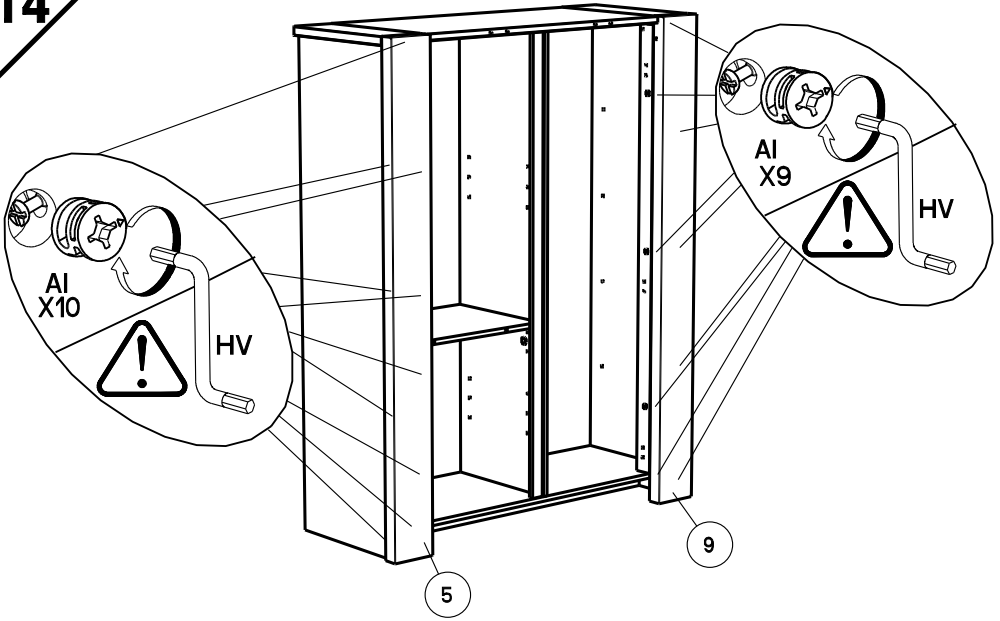

15

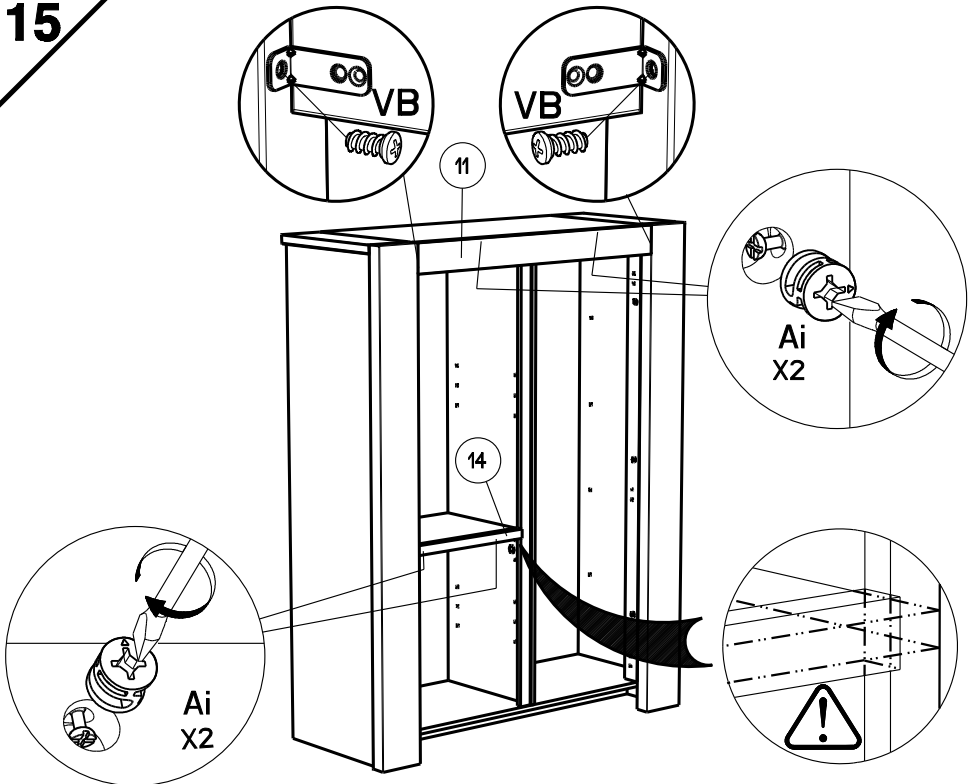

16

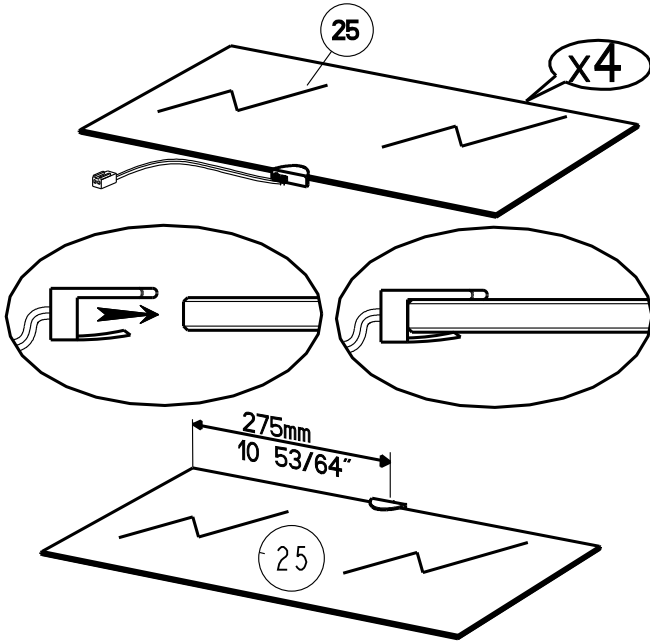

17

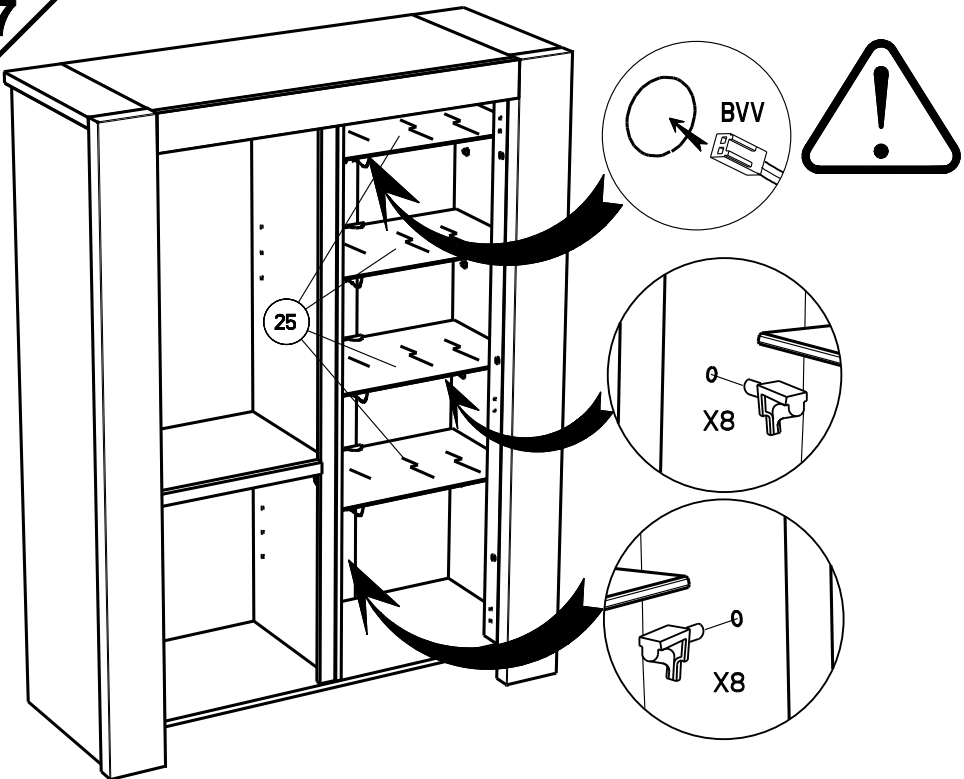

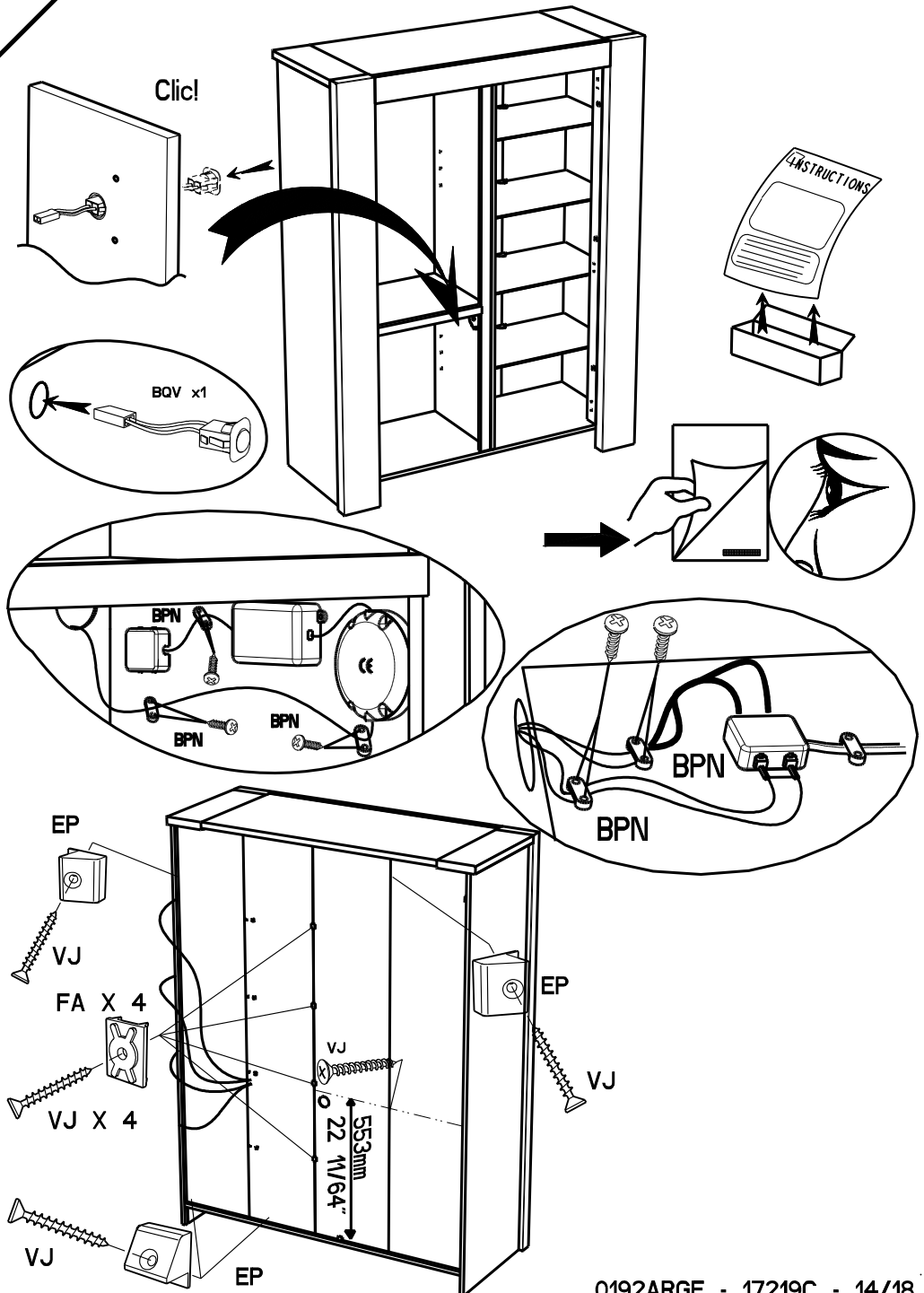

19

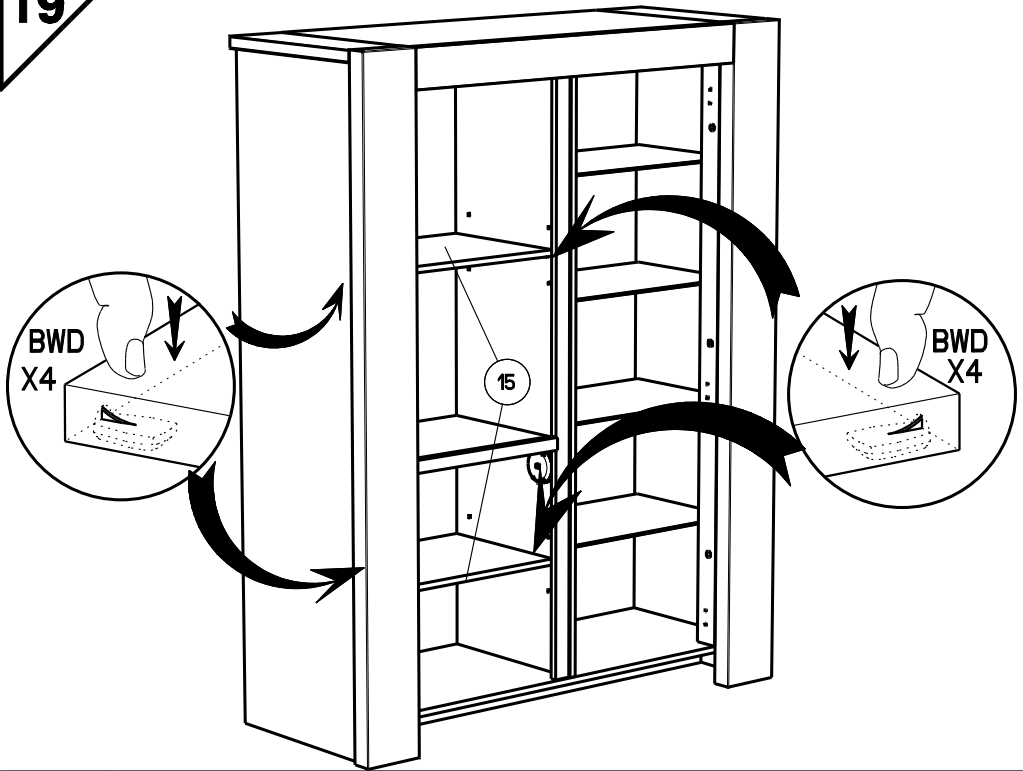

20

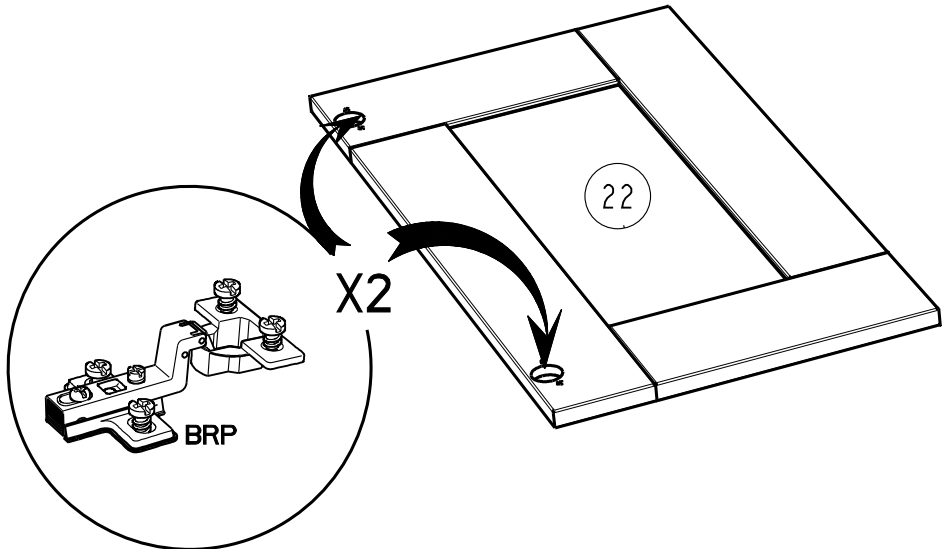

21

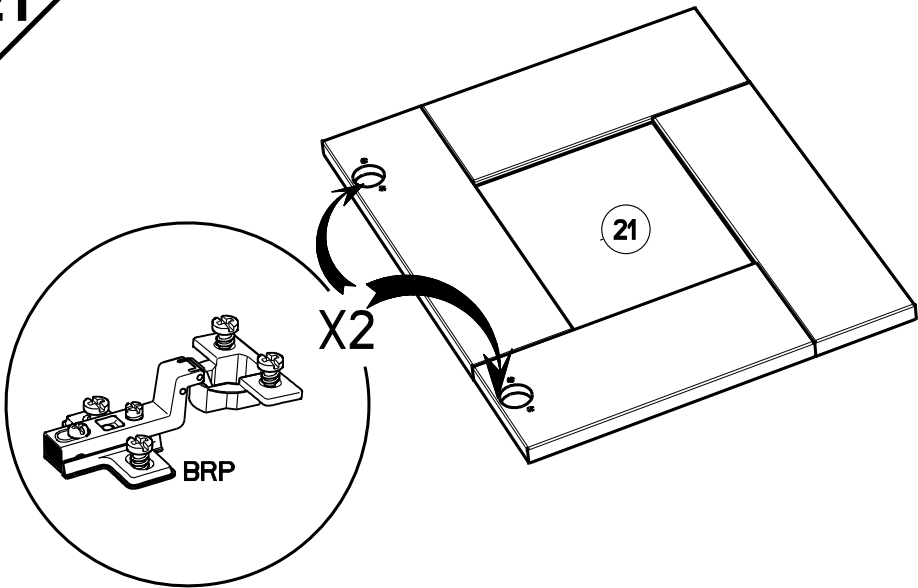

22

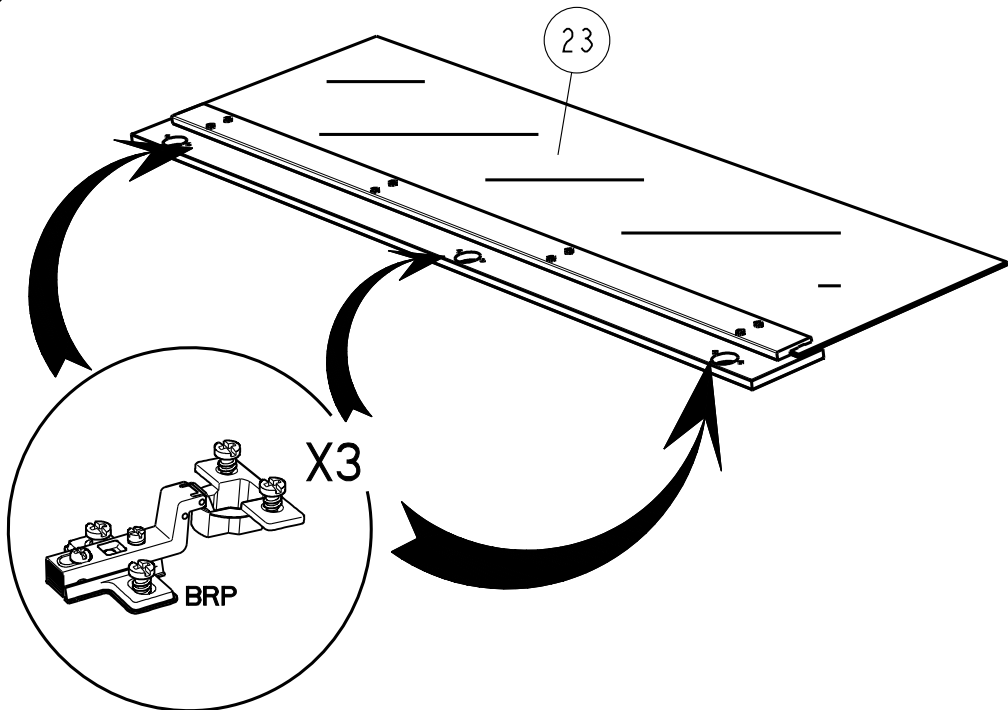

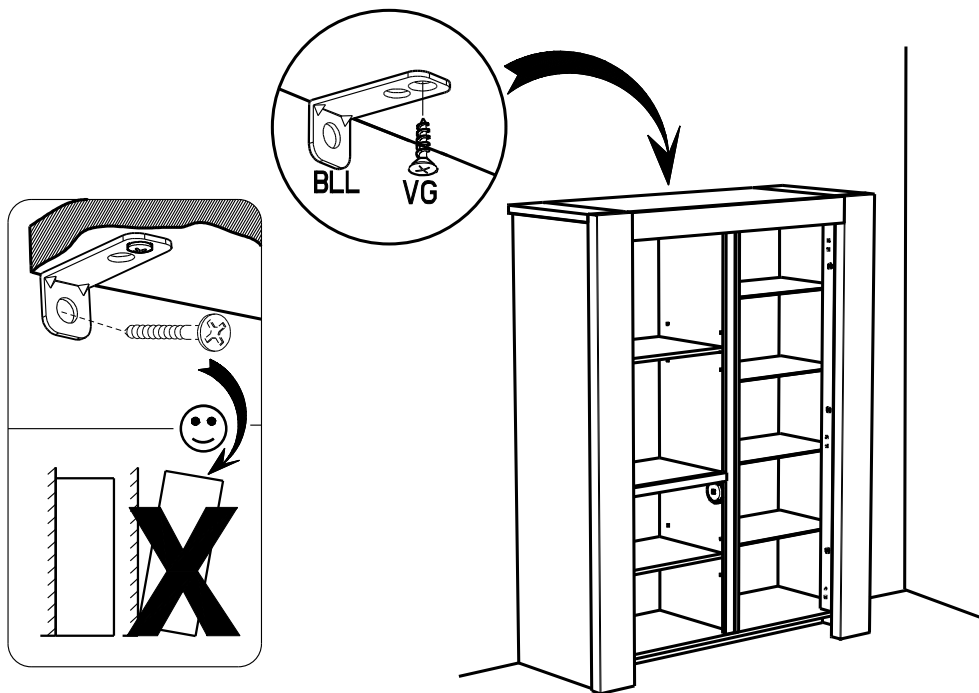

FR Pour votre sécurité : Fixation du meuble au mur
Attention, la fixation doit être réalisée par une personne compétente car cela nécessite des chevilles adaptées à la nature de votre mur.

GB For your own safety: attach the furniture to the wall
Important! The furniture must be attached by a qualified person using dowels that are suited to the type of wall.

D Für Ihre Sicherheit: Befestigung des Möbelstücks an der Wand
Achtung, die Befestigung muss von einem Fachmann vorgenommen werden, weil sie an die Wand angepasste Dübel erfordert.

E Para su seguridad: Fijación del mueble a la pared
¡Ojo! La fijación deberá llevarla a cabo una persona competente ya que necesitará unos tacos adaptados a tipo de pared.

PT Para a sua segurança: Fixação do móvel na parede
Atenção, a fixação deve ser efectuada por uma pessoa competente, pois exige a utilização de cavilhas adaptadas à natureza da parede.

I Per la vostra sicurezza: fissaggio del mobile alla parete.
Nota bene, il fissaggio deve essere eseguito da personale specializzato, poiché l'utilizzo di tasselli adattati alla parete.

NL Voor uw veiligheid: bevestiging van het meubel aan de muur.
Let op, de bevestiging moet worden uitgevoerd door een bevoegd persoon, want hiervoor zijn pluggen nodig die specifiek geschikt zijn voor de betreffende muur.

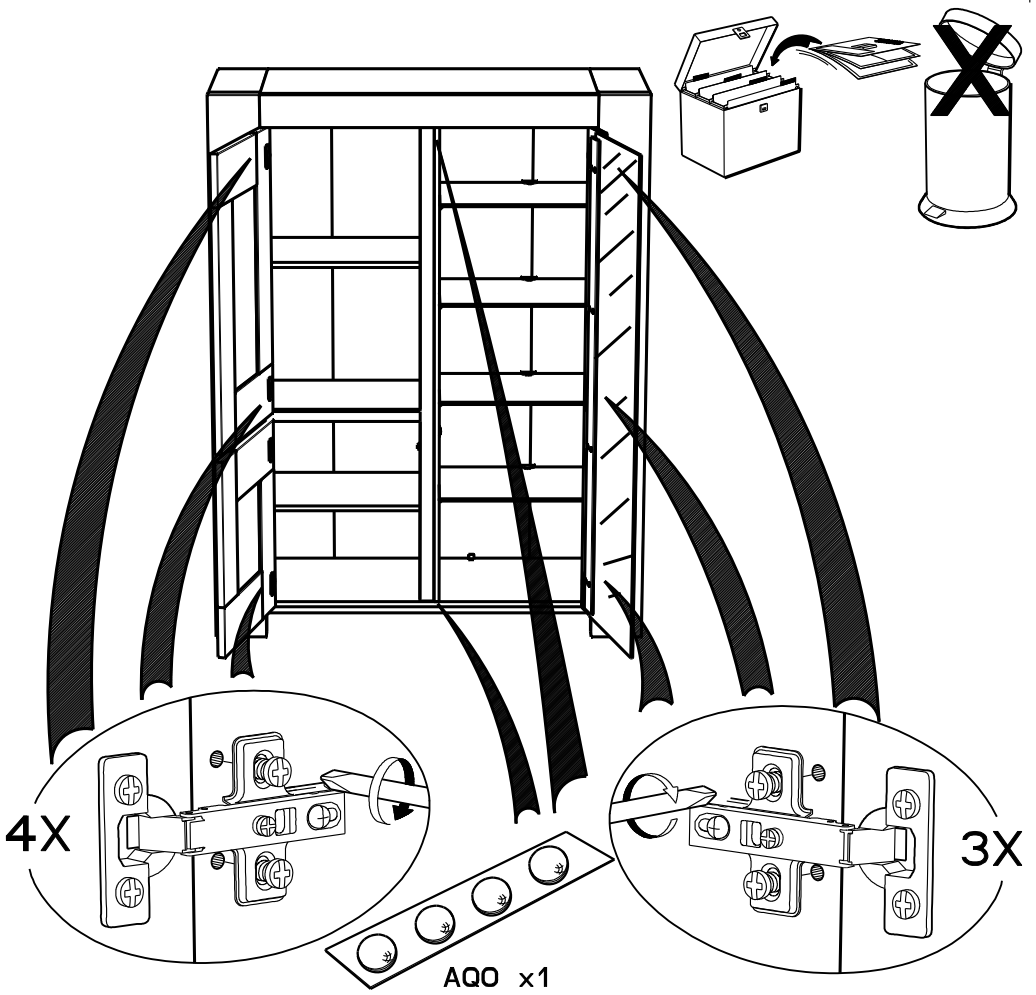

(F) REGLAGE (GB) ADJUSTING (E) AJUSTER (I) AGGIUSTAMENTO
 (D) ANPASSUNG (P) REGULACAO (NL) AFSTELLING

